

# Speed Controller with One-touch Fittings Centralised Piping Type

RoHS

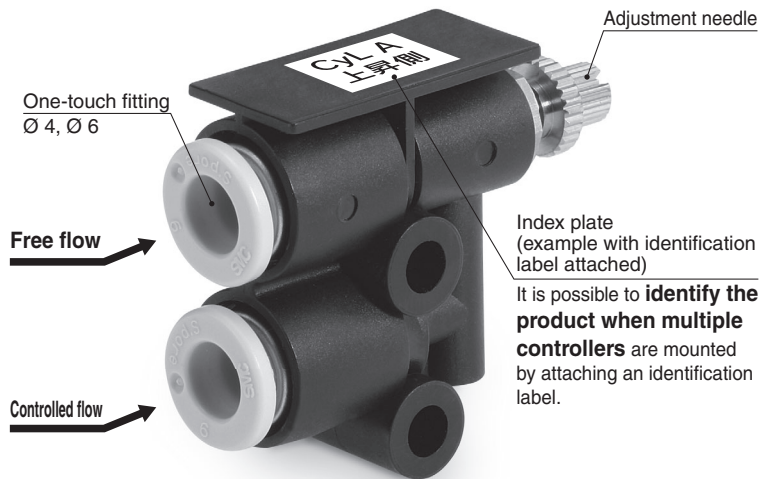

## Installation example

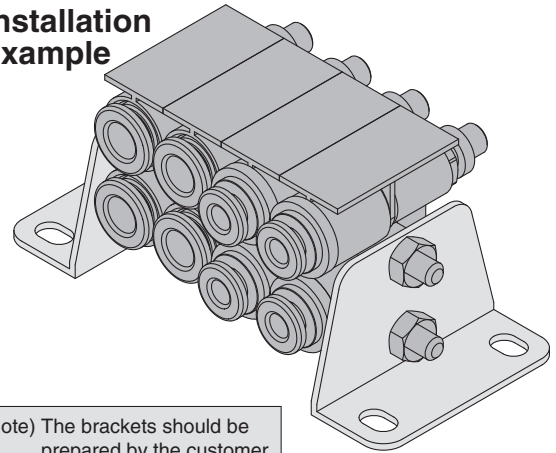

## Specifications

Model	AS-DPP00092	AS-DPP00093
Applicable tubing O.D.	Ø 4	Ø 6
Fluid	Air	
Proof pressure	1.5 MPa	
Max. operating pressure	1 MPa (0.7 MPa <sup>Note 1)</sup> )	
Min. operating pressure	0.1 MPa	
Ambient and fluid temperature	-5 to 60 °C (No freezing)	
Applicable tubing material <sup>Note 1)</sup>	Nylon, Soft nylon, Polyurethane	

Note 1) Use caution at the max. operating pressure when using soft nylon or polyurethane tubing.

(Refer to the **WEB catalogue** at [www.smc.eu](http://www.smc.eu) for details)

Note 2) Brass parts are all electroless nickel plated.

## Flow-rate Characteristics

### AS-DPP00092

### AS-DPP00093

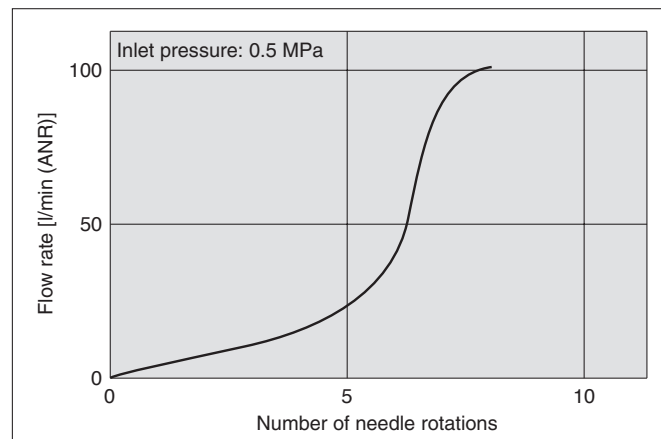

## Dimensions

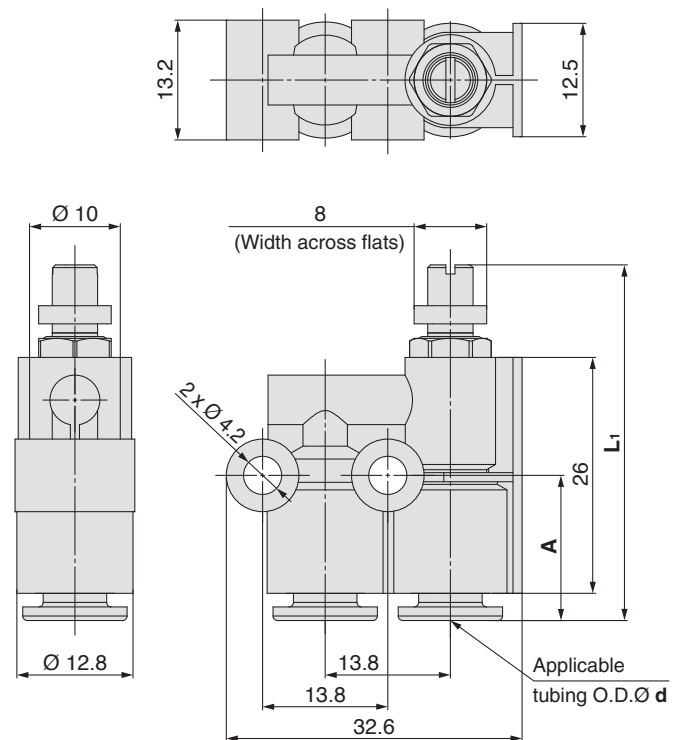

## Dimensions

[mm]

Model	Applicable tubing O.D. d	A	L <sub>1</sub>	
			Max.	Min.
AS-DPP00092	4	19.4	46.9	42.7
AS-DPP00093	6	16	43.5	39.3

# AS-DPP00092/00093



11-EU577-UK